



**FEATURES**

- Temperature range of 27 °C to 93 °C
- 76 cm wide, it's spacious enough for an entrée and several sides
- Matches Wolf ovens, steam ovens, and outdoor grills, or accepts custom panel and handle
- Hidden electronic controls
- Automatic shut-off
- Rigorously tested in our U.S. manufacturing facilities for decades of use
- Exceptional support from our Customer Care team
- UL approved for warming towels
- Four preset temperatures make it easy to warm favorite foods
- Fan assist for even heat distribution that keeps foods fresh
- Removable rack lets you double-stack items
- Full-extension drawer for easy access to foods
- Removable stainless steel drawer pan for easy clean-up

**ACCESSORIES**

- Stainless steel or black glass drawer fronts to match Wolf professional, contemporary and transitional ovens
- Stainless steel professional, contemporary and transitional handles
- Integrated drawer front kit for custom panels
- 6-pc Container Set
- Accessories available through an authorized Sub-Zero dealer.  
For local dealer information, visit [subzerowolf.com.hk](http://subzerowolf.com.hk)



**DRAWER PANEL OPTIONS  
INDOOR USAGE**



76 CM M SERIES PROFESSIONAL



76 CM M SERIES CONTEMPORARY  
STAINLESS STEEL



76 CM M SERIES CONTEMPORARY  
BLACK GLASS



76 CM M SERIES TRANSITIONAL



INTEGRATED CUSTOM DRAWER  
FRONT & HANDLE

**OUTDOOR USAGE**



76 CM 51 MM THICK PROFESSIONAL



91 CM 51 MM THICK PROFESSIONAL



PRODUCT SPECIFICATIONS

Model	ICBWWD300
Dimensions	759 mm W x 264 mm H x 578 mm D
Usable Capacity	44 L
Shipping Weight	45 kg
Electrical Supply	220-240 VAC; 50/60 Hz
Electrical Service	850 W
Power Cord	0.9 m

ELECTRICAL

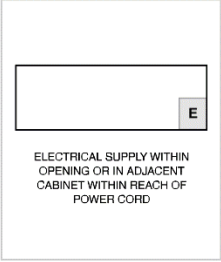

**NOTE:** Dimensions in parenthesis are in millimeters unless otherwise specified

DIMENSIONS

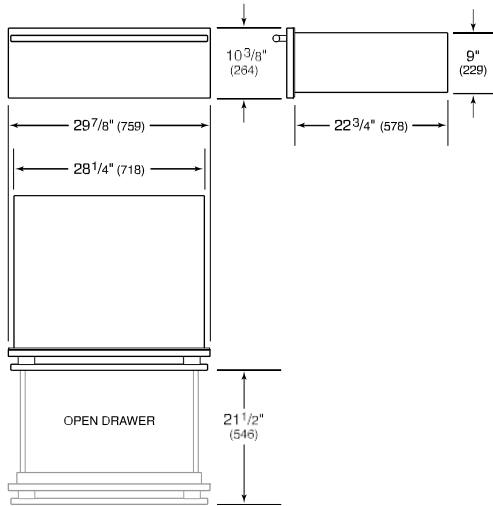

STANDARD INSTALLATION

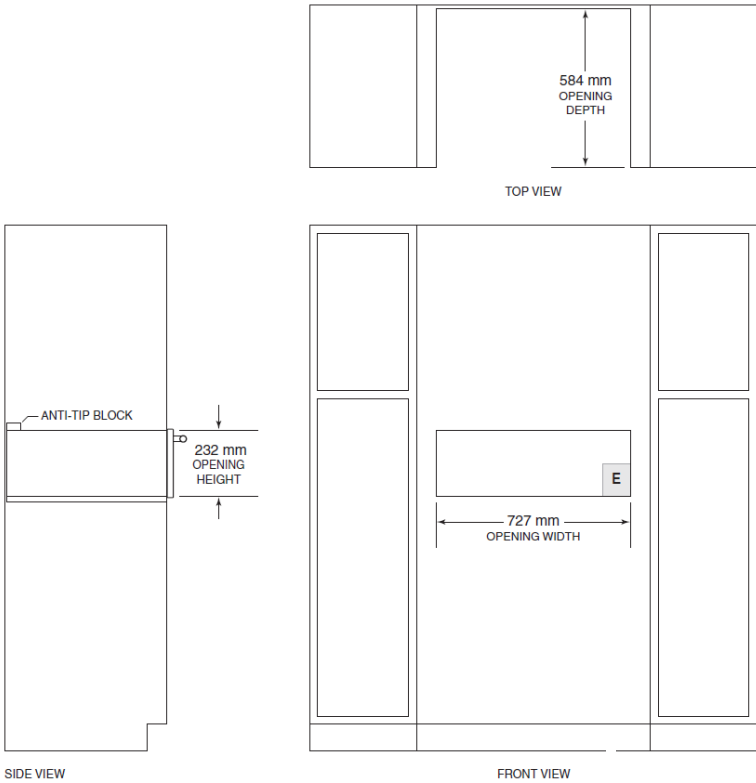

SIDE VIEW

FRONT VIEW

FLUSH INSTALLATION

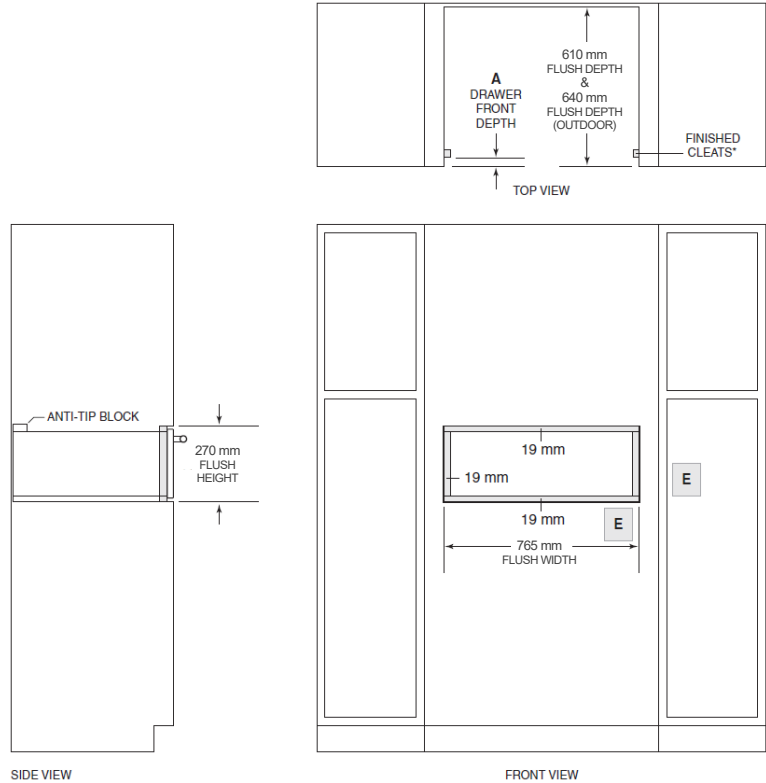

SIDE VIEW

FRONT VIEW

INSTALLATION REQUIREMENTS

Minimum Base Support	90 kg
Trim Overlap (top, bottom, sides)	16 mm

\*Will be visible and should be finished to match cabinetry  
\*\*Dimension provides minimum reveals  
NOTE: Location of electrical supply within opening may require additional cabinet depth

DRAWER FRONT DEPTH (A) M SERIES

Professional / Transitional	22 mm
Contemporary	25 mm
Professional (51 mm thick)	54 mm

Custom front panel depth is dependent on panel thickness.