

ICBSP024TE/S/TH**FEATURES**

Combines microwave, convection, and broil technologies to provide all-in-one oven versatility

Provides more cooking power than a traditional microwave with the help of convection and broil

Assures predictably delicious results with 10 microwave power levels, convenient quick-start modes, and an intuitive Gourmet mode

Fits a 23 x 33 cm pan in the 43 liters, stainless-steel interior

Micro Bake and Micro Roast modes reduce or completely eliminate preheat times

Frees up counter space with efficient drop-down door design

Coordinates with other Wolf built-in ovens and appliances with various handle and trim options

Master your technique with tips and recipes from the Mastering the Speed Oven guide

ACCESSORIES

60 cm Side Trim Kit - Black

Pro Handle

Accessories available through an authorized dealer.
For local dealer information, visit subzerowolf.com.hk.





PRODUCT SPECIFICATIONS

Model	ICBSPO24TE/S/TH
Dimensions	597 mm W x 454 mm H x 546 mm D
Capacity	43 L
Door Clearance	360 mm
Shipping Weight	48 kg
Electrical Supply	220-240 VAC, 50/60 Hz
Electrical Service	2.55 kW
Power Cord	1.8 m

ELECTRICAL

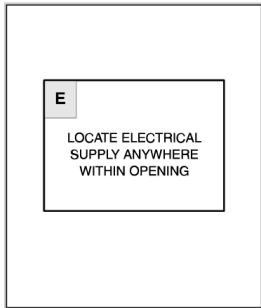

NOTE: Dimensions in parenthesis are in millimeters unless otherwise specified

DIMENSIONS

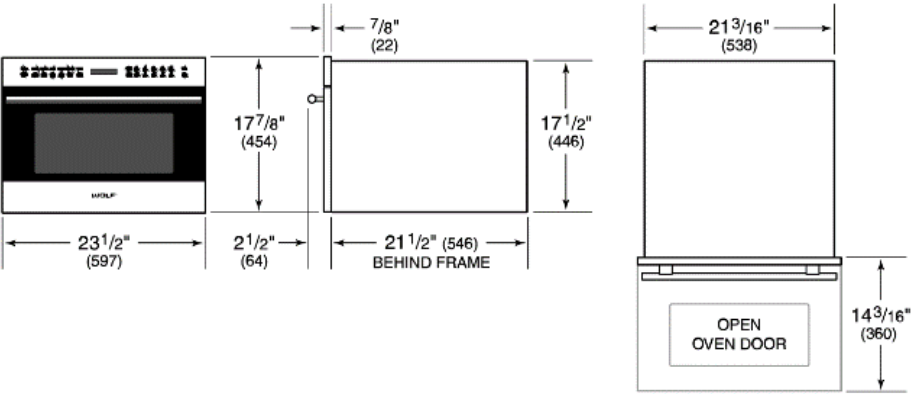

STANDARD INSTALLATION

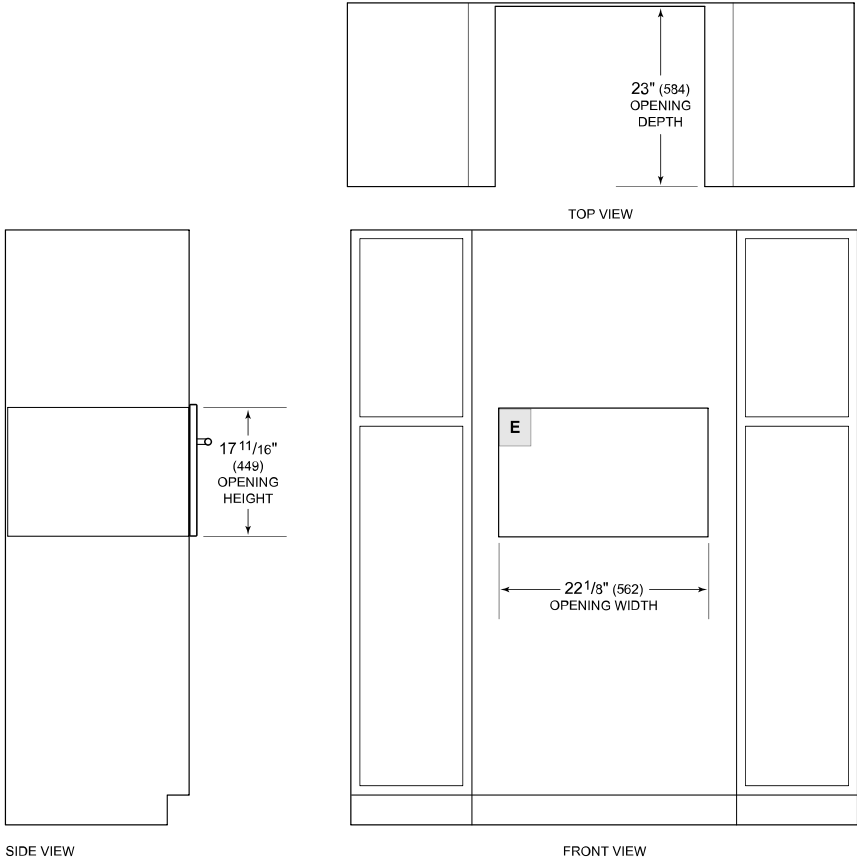

NOTE: Location of electrical supply within opening may require additional cabinet depth.