

ICBCSO3050CM/B

FEATURES

- The elegant, modern aesthetics pair perfectly with a full suite of similarly styled Sub-Zero and Wolf appliances
- Contemporary styling features a completely handleless look that incorporates a motorized door system
- Full-color touchscreen simplifies use
- Save up to 50 personalized favorite recipe presets
- Cooking modes include Steam, Convection, Broil, Slow Roast
- 1750-Watt recessed broil element
- 68 Liter oven cavity allows multiple dishes to be placed side by side at once
- 1889-Watt dual convection system ensures even, multi-rack baking and consistent results
- Three full-extension rack positions and one standard position allow easy access and increased cooking flexibility
- 1.2 Liter tank holds enough water for 2-hours of uninterrupted steam cooking
- The temperature probe alerts you when your dish has reached the desired temperature

ACCESSORIES

- Broiler Rack
- Descaling Solution
- Enameled Broil Pan
- Perforated Pan - 324 x 38 x 178 mm
- Perforated Pan - 629 x 35 x 368 mm
- Solid Pan - 324 x 38 x 178 mm
- Solid Pan - 629 x 35 x 368 mm
- Standard Oven Rack
- Temperature Probe
- Accessories available through an authorized dealer.  
For local dealer information, visit [subzero-wolf.com/hk](http://subzero-wolf.com/hk).



PRODUCT SPECIFICATIONS

Model	ICBCSO3050CM/B
Dimensions	759 mm W x 454 mm H x 572 mm D
Interior Dimensions	641 mm W x 273 mm H x 384 mm D
Overall Capacity	68 L
Usable Capacity	51 L
Door Clearance	360 mm
Shipping Weight	57 kg
Electrical Supply	220-240 VAC; 50 Hz
Electrical Service	3.7 kW
Power Cord	1.2 m

ELECTRICAL

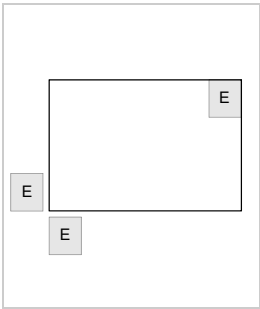

**NOTE:** Dimensions in parenthesis are in millimeters unless otherwise specified

DIMENSIONS

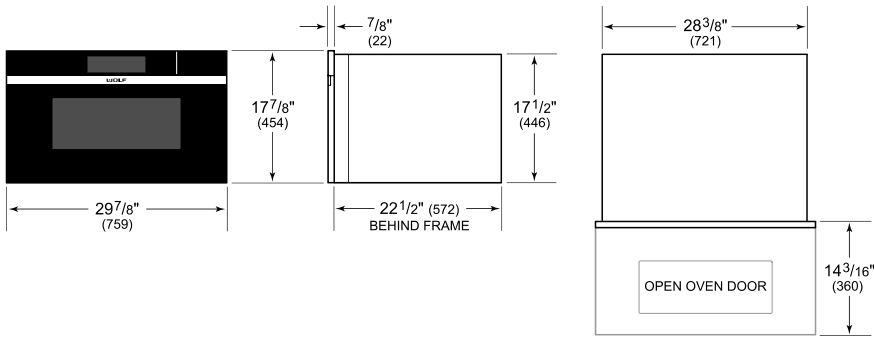

FLUSH INSTALLATION

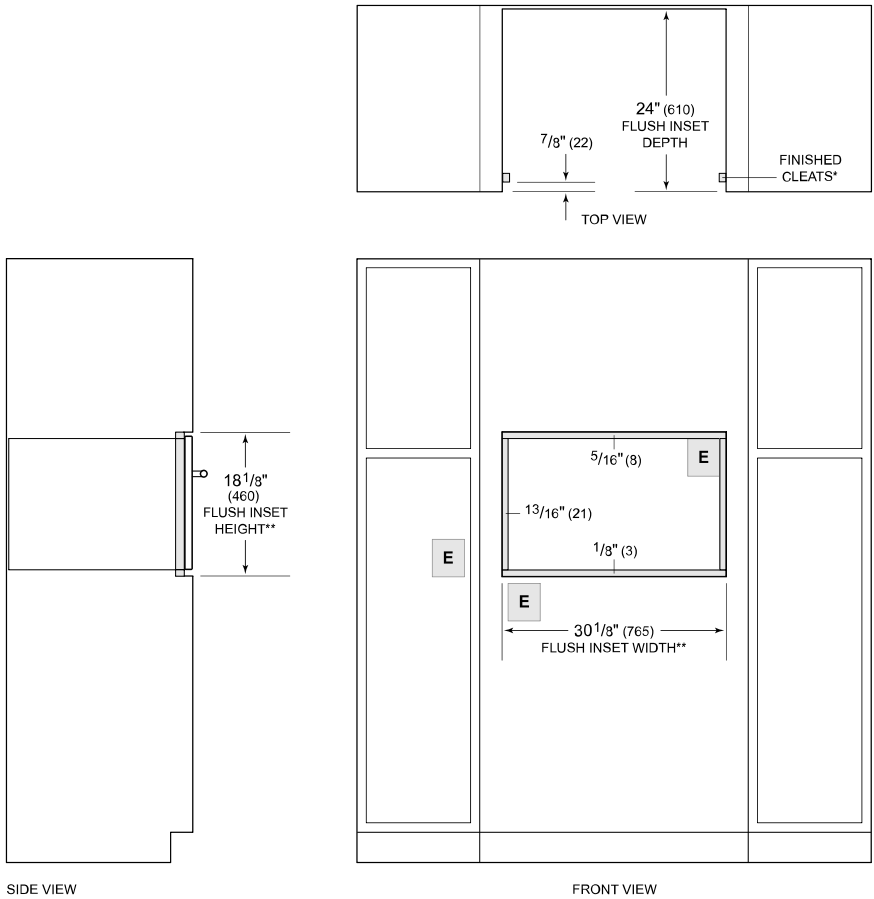

*\*Will be visible and should be finished to match cabinetry.*  
*\*\*Dimension provides minimum reveals.*  
*NOTE: Location of electrical supply within opening may require additional cabinet depth.*