

ICBIW-18



FEATURES

- Custom front panel and hardware allow for infinite design options.
- Dual evaporators for constant, moderate humidity so corks don't dry out
- Two independent temperature zones hold reds and whites at proper serving temperature
- Bronze-tinted, UV-resistant glass protects against light exposure
- Soft-on LED lighting illuminates gradually
- Home security system connection
- Wine racks accommodate 750 ml bottles, half-bottles and magnums.
- Intuitive touch control panel keeps temps within one degree of set point
- Rigorously tested in our U.S. manufacturing facilities to ensure decades of use
- Exceptional support from Customer Care team
- Star-K compliant with installation of a harness kit
- Illuminated display rack for prized bottles of wine
- Full-extension, easy-glide racks provide access without agitating wine
- New inventory tiles system lets you label wine racks for easy ID

ACCESSORIES

- Side enclosure
- Top enclosure
- Stainless steel front panels with tubular or pro handles
- Solid overlay door
- Dual installation kit for installation with another wine or integrated model
- Reduced toe kick divider for toe kicks from 10 cm to 5 cm
- Stainless steel pro handles
- Stainless steel tubular handles

Accessories are available through an authorized Sub-Zero dealer.
For local dealer information, visit subzerowolf.com.hk.



HANDLE ACCESSORIES

PRO



TUBULAR



PRODUCT SPECIFICATIONS

Model	ICBIW-18
Dimensions	457 mm W x 2134 mm H x 610 mm D
Door Clearance	419 mm
Weight	158 kg
Electrical Supply	220-240 VAC; 50/60 Hz
Electrical Service	0.3 A
Wine Storage Capacity	59 Bottles (750 ml)
Receptacle	3-prong grounding-type

ELECTRICAL

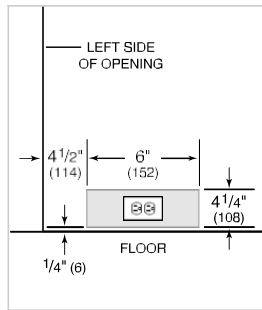

NOTE: Dimensions in parenthesis are in millimeters unless otherwise specified

INTERIOR VIEW



This illustration is intended for interior reference only and may not represent the exterior of the model being specified.

DIMENSIONS

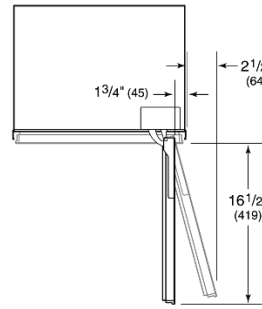
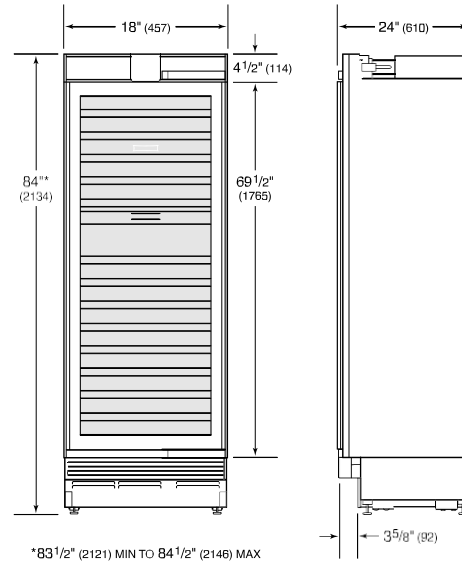

STANDARD INSTALLATION

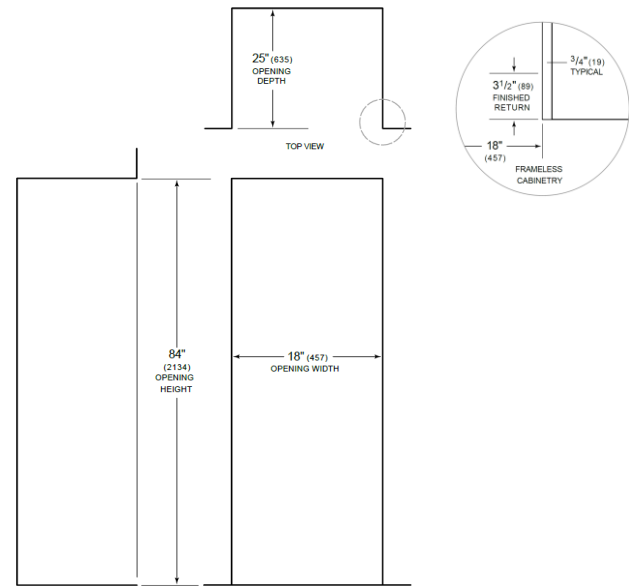

NOTE: 3 1/2" (89) finished returns will be visible and should be finished to match cabinetry. The opening depth assumes 19 mm panel thickness.