

ICBIC-24R



FEATURES

Ready to be fitted with custom panels and handles to blend with cabinetry

All-refrigerator storage solves capacity problems

Nano-coated spill-proof shelves for easy clean-up

Smart-touch controls for streamlined access to more settings

Soft-on LED lights for varying degrees of brightness

Uniform 2134 mm height

Rigorously tested in our U.S. manufacturing facilities to ensure decades of use

Exceptional support from Customer Care team

ACCESSORIES

Stainless Steel Tubular Handles

Stainless Steel Pro Handles

Stainless steel kickplate

Stainless steel side enclosure

Stainless steel top enclosure

Reduced toe kick divider for toe kicks from 5 cm to 10 cm

Accessories are available through an authorized Sub-Zero dealer. For local dealer information, visit subzerowolf.com.hk.



HANDLE ACCESSORIES

PRO



TUBULAR



PRODUCT DETAILS

REFRIGERATOR

- Three adjustable glass shelves
- Two crisper drawers with dividers
- Deli drawer with dividers
- Three adjustable door shelves
- Two stationary door shelves
- Adjustable dairy compartment

PRODUCT SPECIFICATIONS

Model	ICBIC-24R
Dimensions	610 mm W x 2134 mm H x 610 mm D
Door Clearance	572 mm
Weight	154 kg
Refrigerator Capacity	352 L
Electrical Supply	220-240 VAC; 50/60 Hz
Electrical Service	0.7 A
Receptacle	3-prong grounding-type

ELECTRICAL

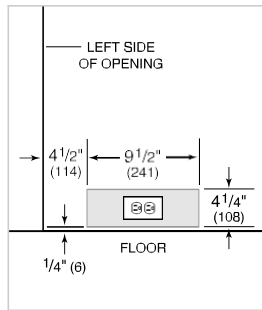

NOTE: Dimensions in parenthesis are in millimeters unless otherwise specified

DIMENSIONS

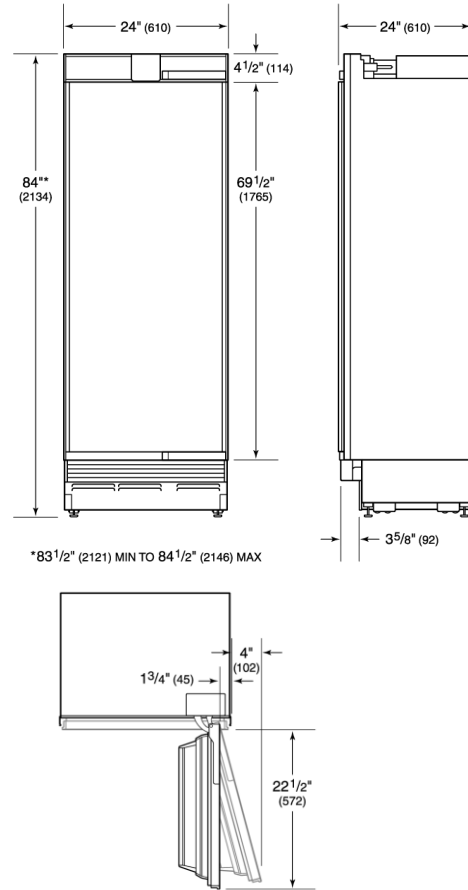

INTERIOR VIEW



This illustration is intended for interior reference only and may not represent the exterior of the model being specified.

STANDARD INSTALLATION

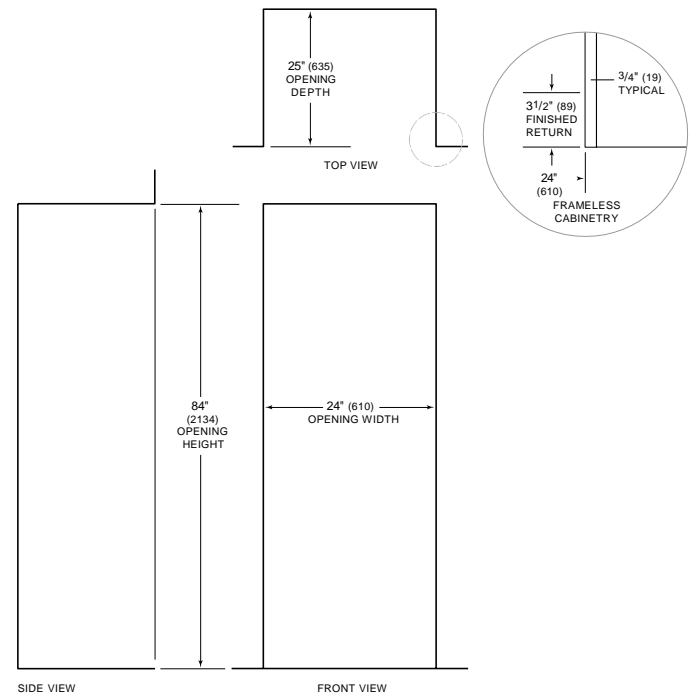

NOTE: 3 1/2" (89) finished returns will be visible and should be finished to match cabinetry