

ICBBW-30



FEATURES

- Stainless steel for a classic Sub-Zero look
- Dual evaporators for constant, moderate humidity so corks don't dry out
- UV-resistant glass door protects against premature wine aging
- Textured roller-glide shelves for access without agitating wine
- Brighter LED lighting makes finding bottles easy
- Intuitive control panel keeps temps within one degree of set point
- Home security system connection
- Inventory tile system for better organization
- Star-K compliant
- Two independent temperature zones hold reds and whites at proper serving temperature
- Rigorously tested in our U.S. manufacturing facilities to ensure decades of use
- Exceptional support from Customer Care team

ACCESSORIES

- Cherrywood humidor
- Bulk storage drawer
- Wine inventory tiles
- Wine inventory tiles -writable
- Dessert wine rack
- Flush inset 76 cm pro louvered grille panel
- Flush inset 76 cm solid stainless steel grille panel
- Flush inset stainless steel front panel with pro handle
- Flush inset stainless steel front panel with tubular handle
- Lock kit
- Stainless steel kickplate - RH
- Stainless steel kickplate - LH
- Stainless steel side panel
- White side panel
- Dual installation kit with or without dual wide grille
-213 cm finished height
- Built-in custom side panel mounting kit
- 90° door stop

Accessories are available through an authorized Sub-Zero dealer.
For local dealer information, visit subzerowolf.com.hk.



HANDLE OPTIONS

PRO



TUBULAR



PRODUCT SPECIFICATIONS

| | |
|-----------------------|---------------------------------|
| Model | ICBBW-30 |
| Dimensions | 762 mm W x 2134 mm H x 610 mm D |
| Door Clearance | 796 mm |
| Weight | 202 kg |
| Electrical Supply | 220-240 VAC; 50/60 Hz |
| Electrical Service | 1 A |
| Wine Storage Capacity | 146 Bottles (750 ml) |
| Receptacle | 3-prong grounding-type |

ELECTRICAL

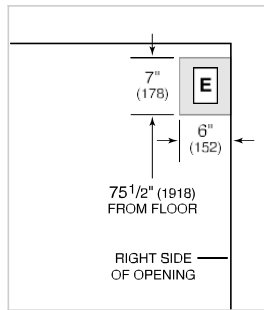

NOTE: Dimensions in parenthesis are in millimeters unless otherwise specified

INTERIOR VIEW

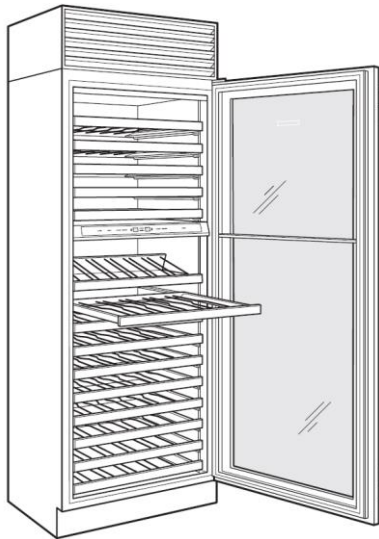

This illustration is intended for interior reference only and may not represent the exterior of the model being specified.

DIMENSIONS

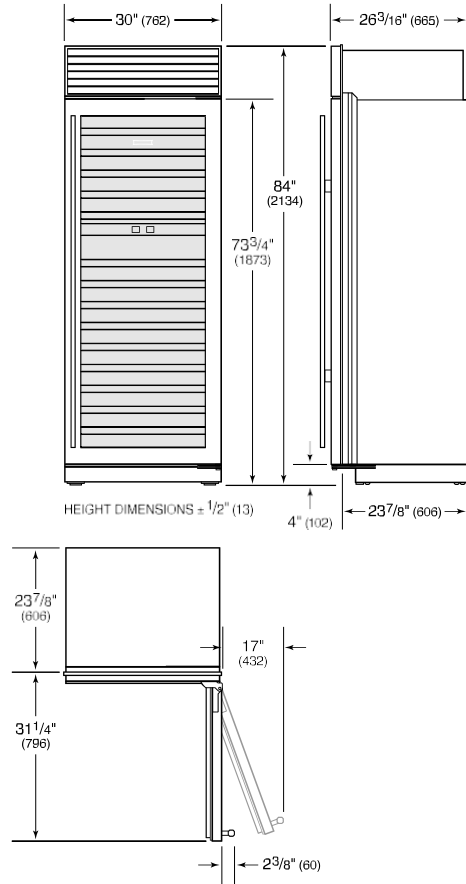

STANDARD INSTALLATION

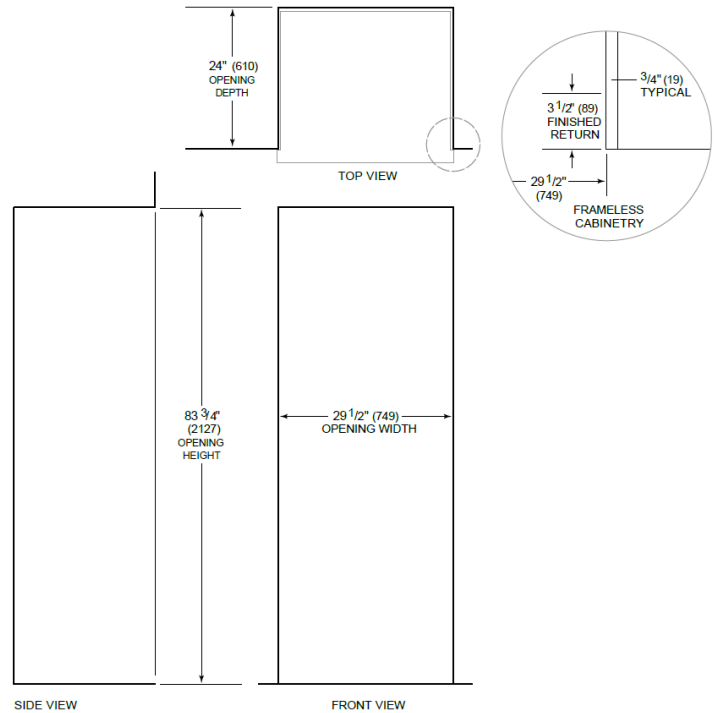

NOTE: Shaded line represents profile of unit.
The opening depth assumes 19 mm panel thickness.