

**ICBBI-48SD/O****FEATURES**

- \_\_\_\_\_ Rigorously tested to ensure decades of use
- \_\_\_\_\_ Exceptional support from Customer Care team
- \_\_\_\_\_ LED Lighting for brighter interior
- \_\_\_\_\_ Dual refrigeration keeps food fresher longer
- \_\_\_\_\_ Air purification system fights spoilage, odours
- \_\_\_\_\_ Microprocessor control assures peak performance
- \_\_\_\_\_ Crispers and deli drawers in low-temp, high-humidity zones for optimum freshness
- \_\_\_\_\_ Freshness cards for maximum food preservation
- \_\_\_\_\_ Magnetic door seal system locks in cold air
- \_\_\_\_\_ Automatic ice maker with "max ice" feature
- \_\_\_\_\_ Adjustable shelves for maximum convenience
- \_\_\_\_\_ Water-filtration system reduces contaminants, chlorine taste and odor
- \_\_\_\_\_ Overlay design accepts cabinetry panels of all kinds

**ACCESSORIES**

- \_\_\_\_\_ Grilles for 2108 mm or 2235 mm finished height (2134 mm is standard)
- \_\_\_\_\_ Flush inset panels in stainless steel with tubular or pro handles
- \_\_\_\_\_ Full-length standard and extended framed handles
- \_\_\_\_\_ Framed front panels in white or stainless steel
- \_\_\_\_\_ Custom front panel mounting kit
- \_\_\_\_\_ Stainless Steel Pro Handles
- \_\_\_\_\_ Stainless Steel Tubular Handles

Accessories are available through an authorized dealer.  
For local dealer information, visit [subzero-wolf.com/locator](http://subzero-wolf.com/locator).

**HANDLE ACCESSORIES****PRO****TUBULAR****PRODUCT DETAILS****REFRIGERATOR**

- 4 Adjustable glass shelves
- 1 High-humidity drawer with divider
- 2 Storage drawers with divider
- 3 Adjustable door shelves
- 2 Stationary door shelves
- Adjustable dairy compartment
- Air purification system

**FREEZER**

- Automatic ice maker
- 3 Adjustable wire shelves
- 3 Storage drawers
- 5 Adjustable door shelves
- Water filtration system

**PRODUCT SPECIFICATIONS**

Model	ICBBI-48SD/O
Dimensions	1219mmW x 2134mmH x 610mmD
Door Clearance	762mm
Weight	298 kg
Refrigerator Gross Capacity	561 L
Refrigerator Storage Capacity	487 L
Freezer Gross Capacity	307 L
Freezer Storage Capacity	228 L
Electrical Supply	220-240 VAC; 50/60 Hz
Electrical Service	≤ 4 A
Receptacle	3-prong grounding-type

**ELECTRICAL**

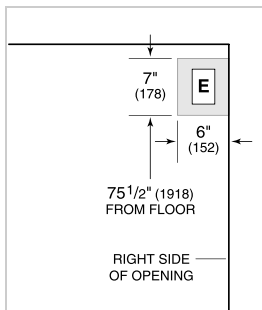

**PLUMBING**

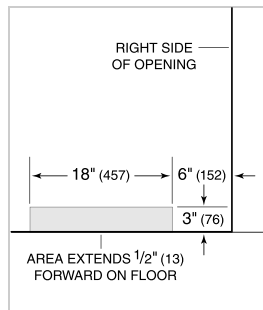

**NOTE:** Dimensions in parenthesis are in millimeters unless otherwise specified

**INTERIOR VIEW**

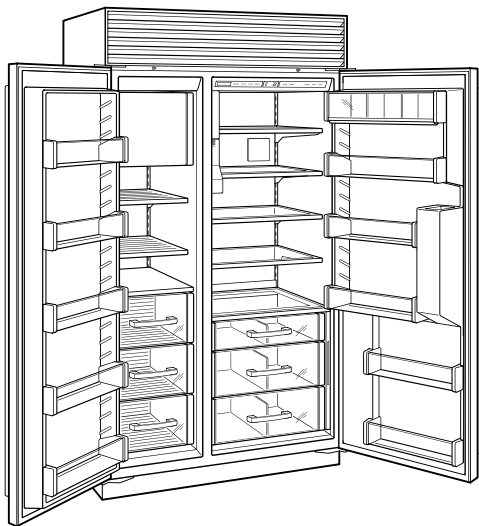

This illustration is intended for interior reference only and may not represent the exterior of the model being specified.

**DIMENSIONS**

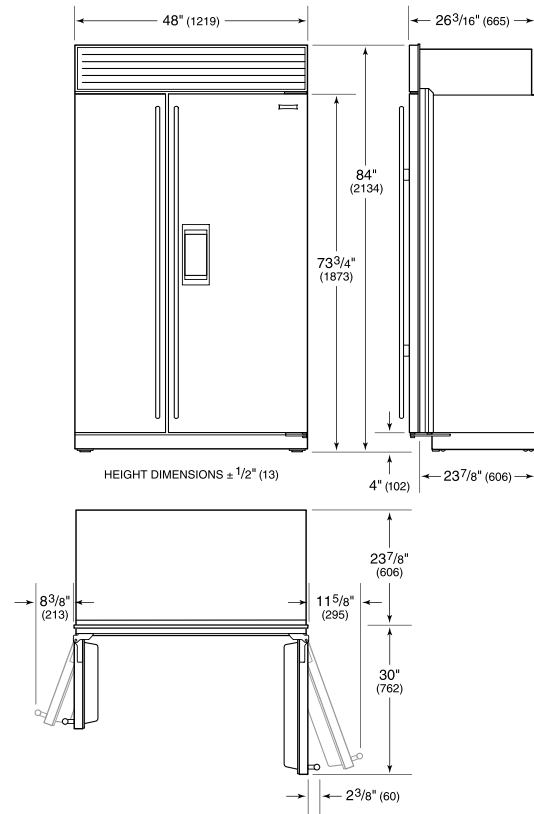

**FLUSH INSET INSTALLATION**

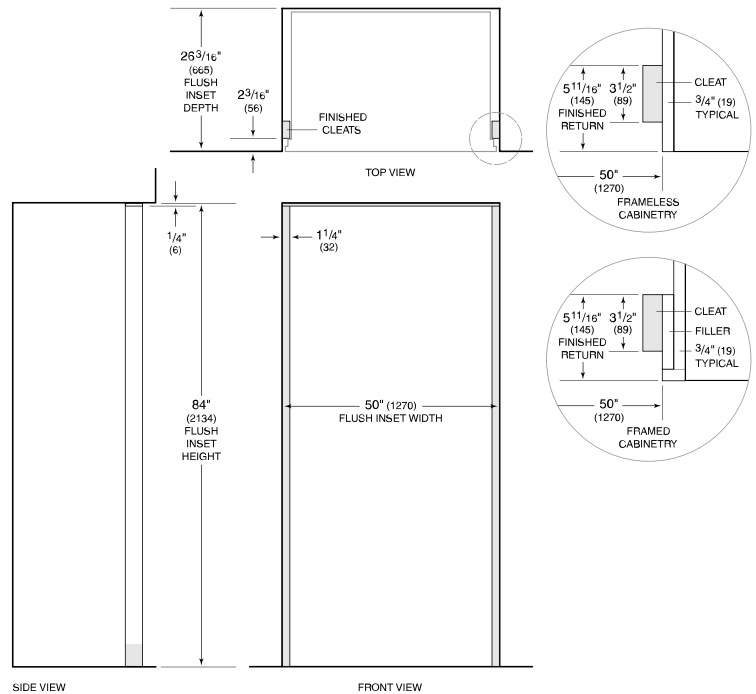

**NOTE:** 3/2" (89) finished returns and shaded areas will be visible and should be finished to match cabinetry. Shaded line represents profile of unit with 3/4" (19) panel.